

The Cajon Division

ORDER BOARD

Pacific Southwest Region

National Model Railroad Association

Volume 22, No. 2

April-June 1993

Superintendents 's Report Spring '94

Ed Hall

Thanks to all who attended the meet in fullerton last February. Everyone seemed to have a good time. The clinician provided a wealth of information in specific aspects of modeling. Tome Van Wormer won the favorite model contest by an overwhelming vote. **He had the only entries.** I hope to see more entries in the coming Riverside meet.

I would like to express my appreciation to the Freight Yard in Anaheim for all the door prizes they donated. Everyone was pleased with their prizes.

As you read this column, I would like to you to think about a problem that we need to resolve in the Cajon division. That problem is attendance. As you know we have tried to schedule events to keep your interests up and make this aspect of the hobby more interesting. there is a need for more fellowship. If you have any ideas of how to peak interest, please let me know. After months of working at my model bench I look forward to up coming train meets. I am proud of my work and like to show my handy work! I find that I am inspired by what others have been doing with their layouts and model building. I know that I am not alone in this need. I find contest, clinics and layout tours to be helpful in my own modeling interest.

The next meet is at Roger Clarkson's home in Riverside. If you have not seen an outdoor layout, Roger has one. He also has a beautifully detailed HO layout. Both are a must see. Roger has done a fantastic job inside and out of his home, reproducing model railroads. I hope that everyone supports this meet and avail themselves of Roger's hospitality.

Don't forget the upcoming PSR '94 Convention in San Diego. After that you can come and relax at the Las Vegas meet in October.

Now that I have all my grumblings out of the way and if you ave any comments write:

Ed Hall

5025 S. Spencer Apt. B

Las Vegas, NV 89119

(702) 739-7270

Cajon Division Meet

There will be a Cajon Division meet at Roger Clarkson's, 1463 Rim Road, Riverside, California from 11:00 am to 5:00 pm **Saturday June 4, 1994.** Rodger has two railroads. A "G" scale outdoor layout that is over 1/3 acre and a 22 x 32 "HO" layout.

We will have clinics, favorite model contest, etc. And the addmission is **FREE!**

Make your plans to attend!!!



Cajon Division Officers

Director	Curtis Roos P.O. Box 1754 Victorville, CA 92393-1754 (619) 951-2122
Superintendent	Ed Hall 5025 Spencer #B Las Vegas, NV 89119-2156 (702) 739-7270
Chief Clerk-Paymaster	Tom Van Wormer P.O. Box 3132 Huntington Beach, CA 92605-3132 (714) 842-6881
Membership	Curtis Roos P.O. Box 1754 Victorville, CA 92393-1754 (619) 951-2122
Contest	Ed Hall 5025 Spencer #B Las Vegas, NV 89119-2156 (702) 739-7270
Program	Todd Scott 42 Montelegró Irvine, CA 92714- (714) 474-5011
Achievement Program	(Chairmanship Vacant)
Member Aid	Hal Carlson Huntington Beach, CA 92646- (714)
Raillette	Marie Lee 19101 Yacht Lane Huntington Beach, CA 92646-2173 (714) 963-3273
Editor - Order Board	Bobby Revis 313 Gardena Ln Las Vegas, NV 89107- (702) 647-1313

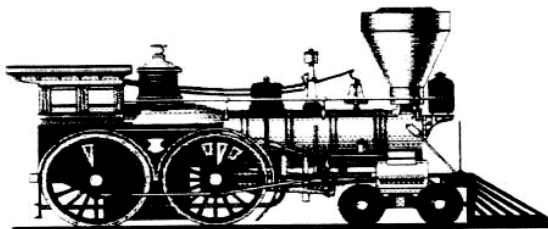

Help wanted

We need an Achievement Program Chairman in the Cajon Division.

If you are interested in one of these areas. Please contact:

Ed Hall	or	Curtis Roos
5025 Spencer #B		P.O. Box 1754
Las Vegas, NV		Victorville, CA
89119-2156		92393-1754
(702) 739-7270		(619) 951-2122

MODEL CONTEST REPORT SPRING '94 Ed Hall

Not much news in the contest category. Tom Van Wormer won first and second place in favorite model contest. They were nicely detailed freight cars of first class quality.

At the next meet (June 4, in Riverside) we will have the favorite model contest again. Merit judging will be available upon request. I have an interest in complete train modeling, and hope in the future to have favorite train contests.

I Hope to see more authentically detailed models at the riverside meet and at PSR '94 Convention in San Diego (September 7-11).

PSR Cajon Division Membership

The current Cajon Division Membership is as follows:

Regular Members	215
Family Members	17
Youth Members	0
Life Members	29
Total Members	261

IN REMEMBRANCE OF CAROL AUSTIN

Carol Austin, wife of Lynn Austin, passed away April 29, 1994. The officers and members of the Cajon division express their deepest sympathy to the Austin Family at the time of this great loss. Carol shared a deep interest in model railroading and was supportive of the Cajon division. We will all miss her very much.

Ed Hall

PSR '94 CONVENTION OVERVIEW

Regional Conventions enable NMRA members to participate in exciting tours, clinics and workshops, great layout viewing at both the conference site, and at homes and clubs. There are fascinating Swap meets and sales by members, manufacturers, and vendors. And meaningful activities for the ladies . . . ALL CLOSE TO HOME!

Much like a national convention, the Southwest has only one Regional Conference a year and if you miss these you are losing one of your most important benefits of NMRA membership as well as updating your state-of-the art information and enthusiasm for your hobby.

San Diego. One of the top convention and tourist cities in the United States, has the honor of hosting model railroaders to a great assembly of displays, technical and artistic information, and just plain FUN!

ISN'T THAT WHAT MODEL RAILROADING IS ABOUT?

If you are a serious modeler, a member of NMRA, a Region, or Division, you just can't miss this exposition! San Diego Division is going full out to provide an event to rival, in scale, a National Convention. We did it in 1974 at the Town and Country Hotel, and we're doing it again at the same Convention Center in 1994.

Imagine this: Over forty clinics and workshops; Over twenty home and club layouts open to attendees; Eighty five thousand feet of manufacturers, retailers sales and individuals in a giant Swap Meet all indoors; Model, display, and photographic arts contest with forty two categories eligible for awards; An eighteen thousand square foot Ballroom loaded with modular, individual, and display train layouts in scales of N, HO, O S, G/I and Live Steam; A large-screen television theater will run Railroad and Feature movies every day and evening, and still some time for socializing.

ALL INCLUDED WITH YOUR REGISTRATION!

However, because of the scope of the displays and swap meet, these two activities will be open to the general public for three days . . . Thursday, Friday, and Saturday, September 8, 9, & 10. Swap Meet on Saturday 8:00 AM to 12 Noon.

The public should also know this is **NOT** your ordinary Toy Train Show. Displayed are the efforts and expertise of serious model makers specializing in construction, structures, scenery, mechanical and electrical engineering, computer aided design, and

The old adage "something for everyone" was never more appropriate than at PSR '94. September 7 through 11, 1994. In addition to the standard fare are the special events and evenings.

On Friday there will be a buffet with open bar, an operating session, and an auction.

A Saturday morning Hobo Breakfast, the afternoon contest judging of models, displays, layouts, photographic submissions, and crafts, followed by the Swap Meet. The evening Awards Dinner offers excellent food, drink, and entertainment.

Tours are always popular and we have some outstanding ones:

EXCLUSIVE . . . Visit to the Thomas Seton Home Museum containing the world's famous and largest toy train collection, layout and the most complete "Buddy L" toy truck collection, then on to the beautifully restored private car, the Cyrus K. Holiday. Note: this tour does not exist for the public.

Also . . . are the S. D. Model Railroad Museum, the S-D. Railroad Museum Tour, train ride and Lunch, The S. D. & Imperial Valley yard Tour and Lunch, and North County Rail Transit Center Tour via AMTRAK, to Oceanside. Many non-rail tours are also planned.

Make this a Family vacation! It's all here: the weather, beaches, mountains, lakes and bays. Attractions like Sea World, the Wild Animal Park, famous San Diego Zoo, Seaport Village, the Gaslamp Quarter, Harbor Tours and Whale Watching, Day Cruises to Ensenada, Mexico, and excellent fishing, golf, and tennis anyone?

AND YOU CAN DRIVE HERE!

At the Convention Center we'll have an all day and evening central lounge with refreshments for relaxing between events and socializing.

Railettes, wives and lady friends will have their own private SUITE furnished in Victorian Motif, and located next to the pool, the boutique, coffee shop and ice cream parlor. Especially organized tours, classes, fashion, makeup, and craft demonstrations in addition to any and all railroad activities.

for registration information

Ralph Oxhandler, Registrar
454 Ferrara Way
Vista, CA 92083-4802
(619) 941-5407



PSR '94 CONVENTION
REGISTRATION FORM
SEPTEMBER 7-11, 1994 - SAN DIEGO

NOTE: Print or type all names as they are to appear on badges.
RAIL NON-RAIL YOUTH*

NAME _____
NAME _____
NAME _____
NAME _____
Are any of the above people handicapped? Yes _____ No _____
ADDRESS _____ PHONES (____) _____
(____) _____
CITY _____ STATE _____ ZIP _____

NMRA #	PSR #	OTHER REGION & #	
FULL, FARE BEFORE 5/2/94	\$50.00	How Many?	\$ _____
FULL FARE AFTER 5/1/94	\$60.00	How many?	\$ _____
*YOUTH FARE (AGE 6 - 18)	\$20.00	How many?	\$ _____
Banquet Sat Eve	\$25.00	How many?	\$ _____
Thomas Sefton Car & Layout Tour	\$25.00	Fri	\$ _____
S.D. Model Railroad Museum 10 Day Pass	\$17.00		\$ _____
S.D. Railroad Museum Tour & Lunch	\$30.00	Sat	\$ _____
S.D. & Imperial Valley Tour/Lunch	\$12.00	Thur	\$ _____
North County Rail Transit Ctr Tour	\$20.00	Fri	\$ _____
Balboa Park Museums Rail on non-rail	\$25.00		\$ _____
TOTAL ENCLOSED			\$ _____

Please reserve accommodations at the Town & Country, 500 Hotel
Circle North, San Diego (Intersection of Fwy 163 & I-8) for:
Name _____

Address _____

City _____ State _____ ZIP _____

Arrival Date & Time _____ Departure Date _____

Credit Card # _____ Expiration Date _____

Signature: _____

Rates: 1 person-\$65.00; 2 people-\$75.00; 3 people-\$85.00;
4 people-\$95.00. Circle accommodation desired.

Check-in time is 3:00pm. Checkout time is noon.

Do you want a no-smoking room?: Yes _____ No _____

Reserve 4 nights get an HO convention car & \$10 credit toward the
banquet/extra fare tours.

+Reserve 3 nights get \$10.00 credit toward banquet/extra fare tours.

+Reserve 2 nights get \$5.00 credit toward banquet/extra fare tours.

SEND ALL OF THIS FORM, WITH CHECK PAYABLE TO "PSR '94" TO: Ralph Oxhandler,
Registrar, 454 Ferrara Way, Vista, CA 92083-4802 (619)941-5407

Cajon Division Timetable

1994

May 18 - 22	Union Pacific Historical Society 10th Annual National Convention & " City of Los Angeles " Train Excursion	August 14 - 21	NMRA National Convention Portland, OR
May 25- 30	PCR '94 Convention 50th Anniversary Santa Clara, CA	September 7-11	PSR '94 Convention - San Diego, CA
June 4	CAJON DIVISION MEET Riverside, CA 11 am - 5 pm	October 15	CAJON DIVISION MEET Las Vegas, NV
June 11 & 12	Big Train Show - Queen Mary Long Beach, CA	November 12 & 13	Great American Train Show Long Beach Convention Center Long Beach, CA
August 13 & 14	Great American Train Show Fairplex - Pomona, CA	December 17 & 18	Great American Train Show Orange County Fairgrounds Costa Mesa, CA

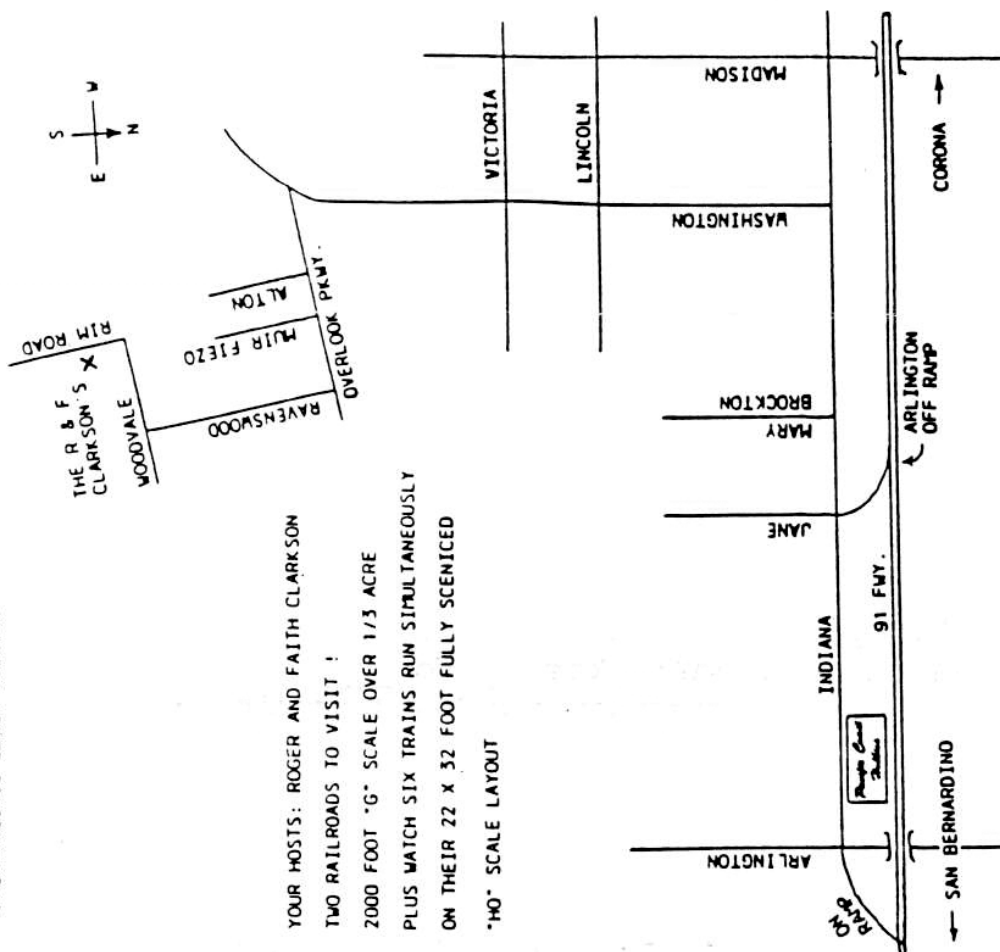
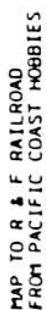
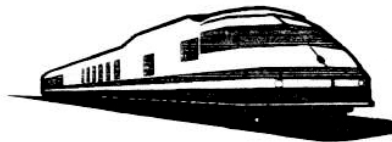

DIRECTIONS:
TAKE INDIANA WEST TO WASHINGTON (ABOUT 1/4 MILE) AND TURN LEFT.
GO SOUTH ON WASHINGTON TO OVERLOOK PKWY AND TURN LEFT AGAIN.
IN ABOUT THREE BLOCKS TURN RIGHT ON RAVENSWOOD, THEN RIGHT AGAIN
ON WOODVALE. TURN LEFT ON RIM ROAD AND THE CLARKSON'S (AT ADDRESS
1463 RIM ROAD) WILL BE ON THE LEFT. ENJOY YOUR VISIT.

MEMBERSHIP APPLICATION
PACIFIC SOUTHWEST REGION, NATIONAL MODEL RAILROAD ASSOCIATION, INC.
7665 EAST SPOUSE DRIVE # 3, PRESSCOTT VALLEY, AZ 86314-5222

I enclose ☐ Check ☐ Money Order ☐ Charge

<input type="checkbox"/> Regular, One Year	\$29.00	<input type="checkbox"/> Youth, One Year	\$19.50	<input type="checkbox"/> Sustaining, One Year	\$58.00
<input type="checkbox"/> Regular, Two years	\$58.00	(Under 20 Years)		<input type="checkbox"/> Life Membership	Apply to the above
<input type="checkbox"/> Family Member, One Year	\$6.00	<input type="checkbox"/> Affiliate, One Year	\$18.00	address with date of birth for quotation	

(Available to Spouse or Minor Child of Regular Member) (No Bulletin)

(U.S. Funds Only) ☐ NEW ☐ RENEWAL

Annual Dues of \$24.00 Includes \$13.00 for subscription to the Bulletin.

Date of Birth _____

Scale & Gage _____

Special Interests (include prototype) _____

Name _____

Charge to: ☐ American Express ☐ Visa ☐ Master Card

Street _____

☐ Dinner's Club ☐ Discover

City _____

Exp. Date _____

CARD NUMBER

□ □ □ □ □ □ □ □ □ □ □ □ □ □ □ □ □ □ □ □

State & Zip _____

Signature _____

Introduced by _____ NMRA # _____
Cajon Division ORDERBOARD, PSR-NMRA (REMOVE OR SEND FACSIMILE) 1/94



ORDER BOARD
Official Publication of
Cajon Division, PSR-NMRA
P.O. Box 1754
Victorville, CA 92393-1754



DATED MATERIAL - PLEASE DO NOT DELAY